

# For Every **SEASON...**

# For Every **REASON**



**CONVENTIONS**

**SPORTING EVENTS**

**SCHOOL FUNCTIONS**



**REUNIONS**

**BANQUETS**

**EXPOS**



**ICE ACTIVITIES**

**TRADE SHOWS**

- 30,000 Sq. Ft. East Arena
- 22,000 Sq. Ft. West Arena
- Over 50,000 Sq. Ft. Under One Roof
- 9 Locker Rooms
- FREE Wireless Internet
- Large, Convenient FREE PARKING
- Centrally Located in Southern Minnesota
- Concessions by Owatonna Youth Hockey
- Elevator to Upstairs Mezzanine
- Two Conference Rooms

**BUILDING LAYOUT ON BACK**

**507.451.1093**

Email: [fourseasons@ll.net](mailto:fourseasons@ll.net)

1525 S. Elm Avenue • Owatonna, MN 55060

[www.co.steele.mn.us/fourseas.html](http://www.co.steele.mn.us/fourseas.html)



**Contact the Four Seasons Centre  
For Your Next Event!**



# Four Seasons Centre Floor Plan

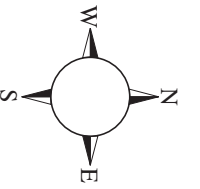

ROOM	SQ. FT.	DIMENSIONS	CEILING	THEATER	STAGE	BANQUET
East Arena	30,000	129' x 222'	25' - 30'	1500	2000	1100
West Arena	22,000	104' x 215'	20' - 25'	1000	1000	600
Upstairs Mezzani Conference Room	2,457	39' X 63'	9'10"	200	N/A	120
Front Room Conference Room	644	23' X 28'	8'9"	75	N/A	50

Miscellaneous equipment included: 96 8 ft. Tables, 800 Chairs, Small Platform Stage, 16' Small Stage, 32' Showmobile Stage, Plenty of Electrical Power.

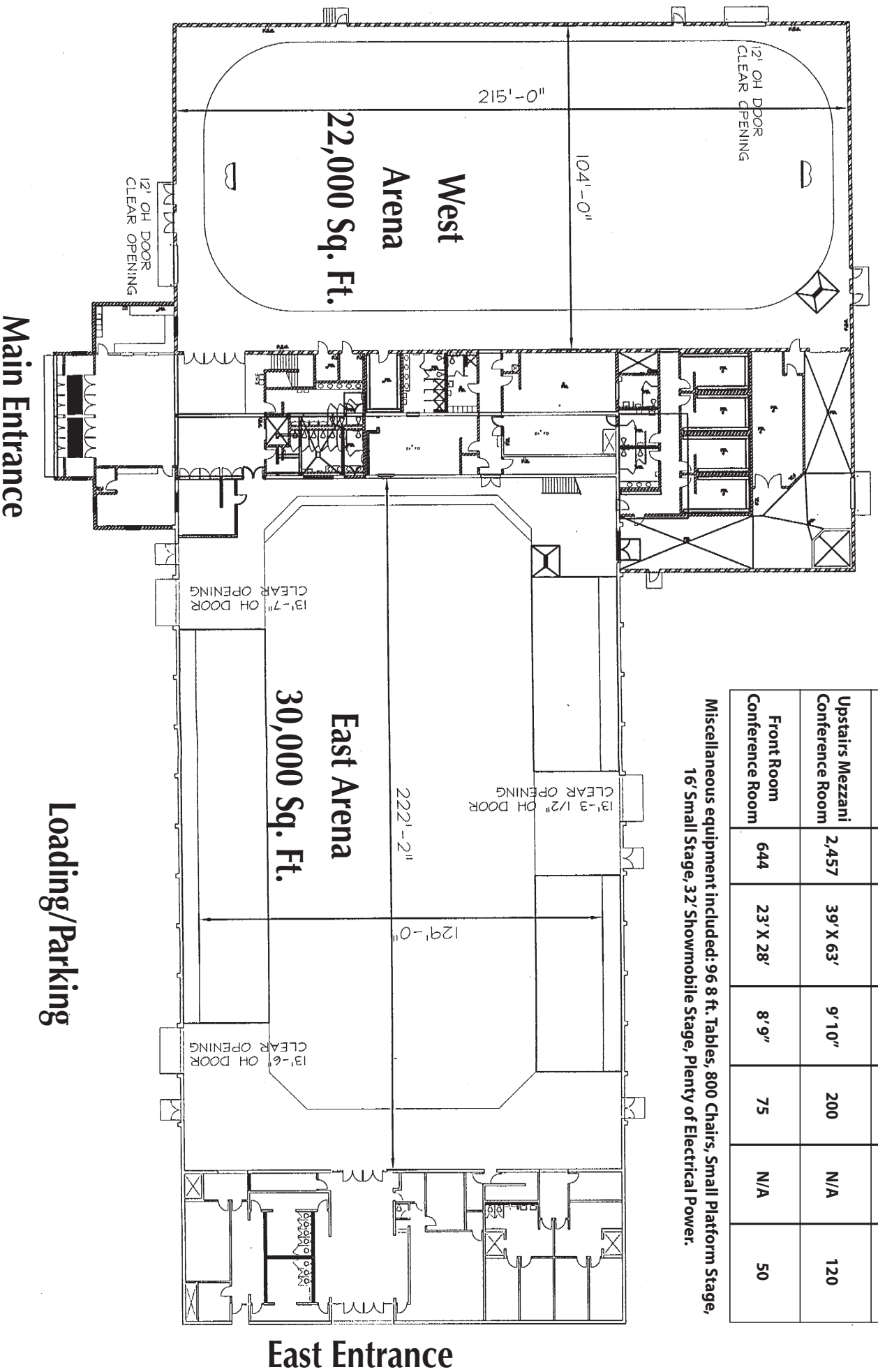

Main Entrance

Loading/Parking

East Entrance